

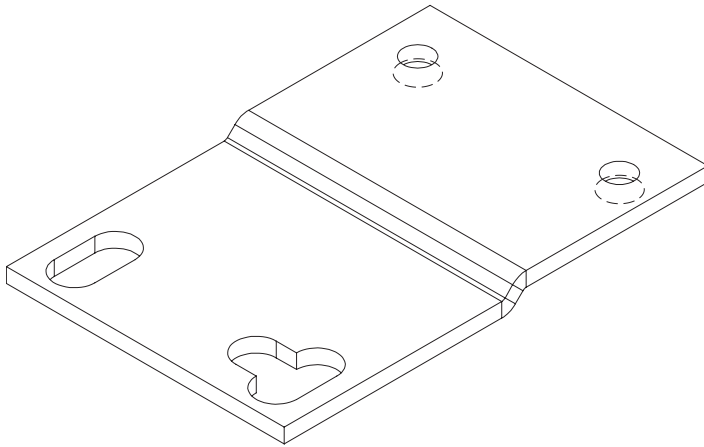

# PPBRKT-1.75

Pair of brackets adapting 19-inch 1-RU equipment to 23-inch racks

LEFT BRACKET:



RIGHT BRACKET:

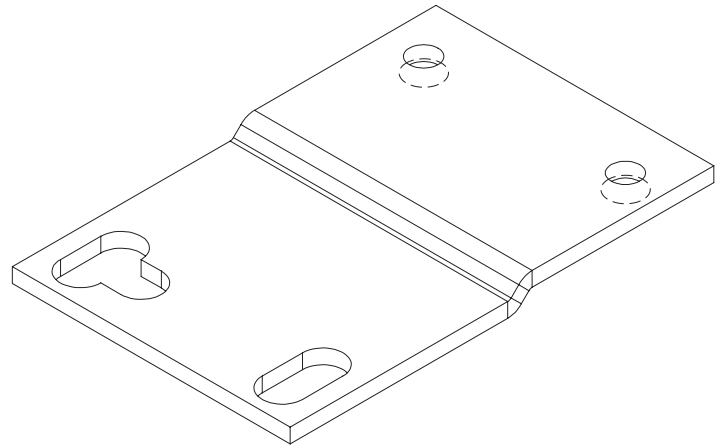

CBM of America's PPBRKT-1.75 is a bracket designed for mounting 1-RU, 19-inch equipment in 23-inch bays or relay racks. It supports racks with 1-inch or 1.25-inch hole spacing. These brackets are constructed of 13 gauge steel and coated in a smooth gray powdercoat.

The PPBRKT-1.75 package contains a left and right bracket and four 12-24 x 3/8 inch zinc-plated, panhead, cross-drive screws with integral lock washers (external-tooth star type).

## Physical Layout and Dimensions

