

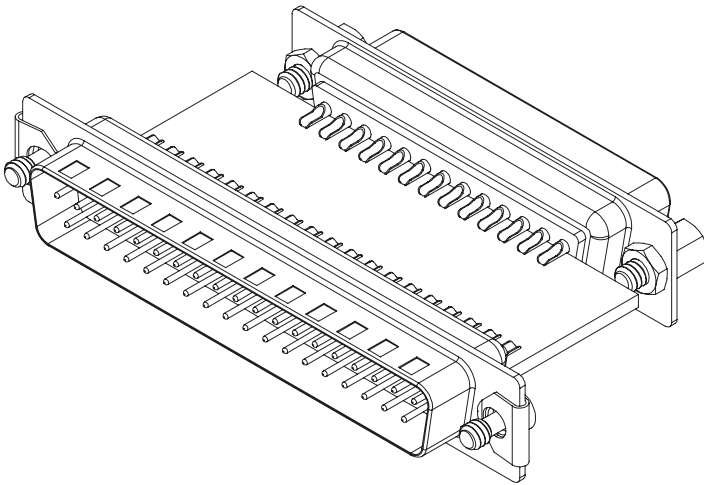

ADP-DACS2

Low-profile RS-423 over DB-37 to RS-232 over DB-25 adapter, designed for Alcatel-Lucent DACS II frame controllers

FRONT VIEW:



REAR VIEW:

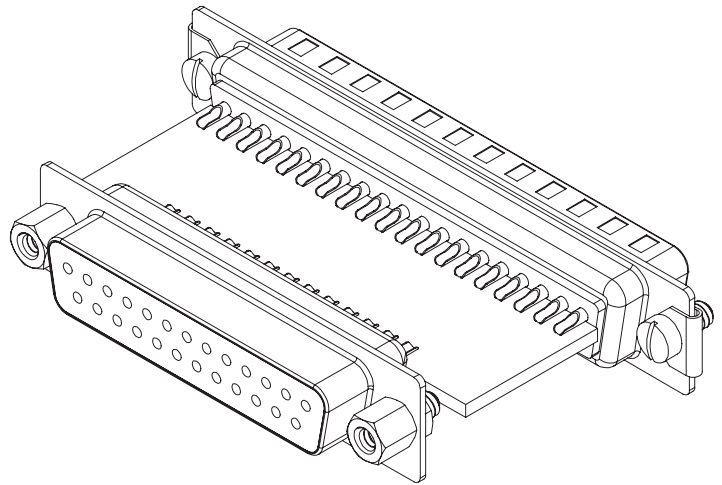

CBM of America's ADP-DACS2 is an adapter designed to convert the RS-423 circuit presented at the Alcatel-Lucent DACS II frame controller's DB-37 port to RS-232 over a DB-25 connector with standard pinning. The device has a minimum width and height no larger than the DB-37 connector itself to make it mechanically compatible with the confined port area on the rear of the DACS II controller. Male and female 4-40 screws and standoffs secure the adapter and associated cable.

Physical Layout and Dimensions

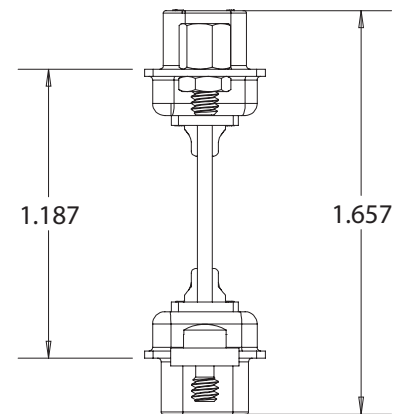
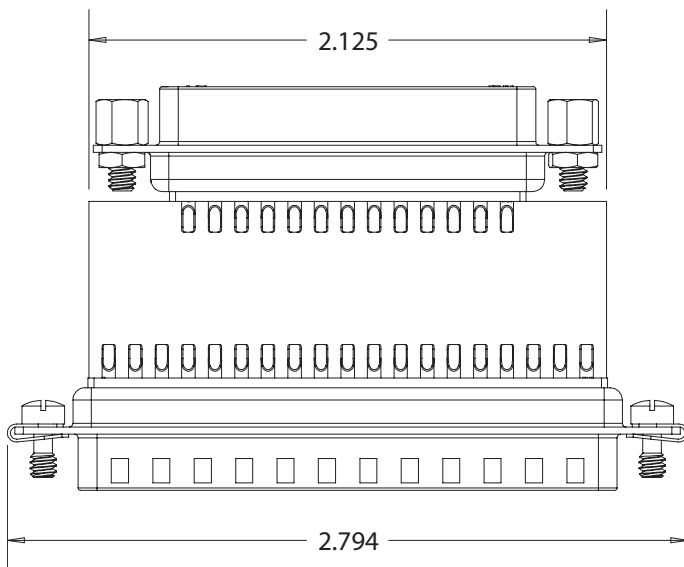

Pinout

Signal names in the following table are referenced to the DACS II port, which presents DTE. Note that pins 19, 20, 23, 24, 26, 27, 29, 31, and 37 of the DB-37 side are connected to a common ground, pin 7 of the DB-25 side.

DB-37 Pin	Signal Name (RS-423)	Direction	Signal Name (RS-232)	DB-25 Pin
1	Shield	—	Shield	1
4	SD-A (Send Data)	→	TxD	2
5	ST-A (Send Timing A)	←	TxC	15
6	RD-A (Receive Data A)	←	RxD	3
7	RS-A (Request to Send A)	→	RTS	4
8	RT-A (Receive Timing A)	←	RxC	17
9	CS-A (Clear to Send A)	←	CTS	5
11	DM-A (Data Mode A)	←	DSR	6
12	TR-A (Terminal Ready A)	→	DTR	20
13	RR-A (Receiver Ready A)	←	DCD	8
19	SG (Signal Ground)	—	SG	7
20	RC (Receive Common)	—		
23	ST-B (Send Timing B)	—		
24	RD-B (Receive Data B)	—		
26	RT-B (Receive Timing B)	—		
27	CS-B (Clear to Send B)	—		
29	DM-B (Data Mode B)	—		
31	RR-B (Receiver Ready B)	—		
37	SC (Send Common)	—		